

VAPOR INTRUSION RESULTS

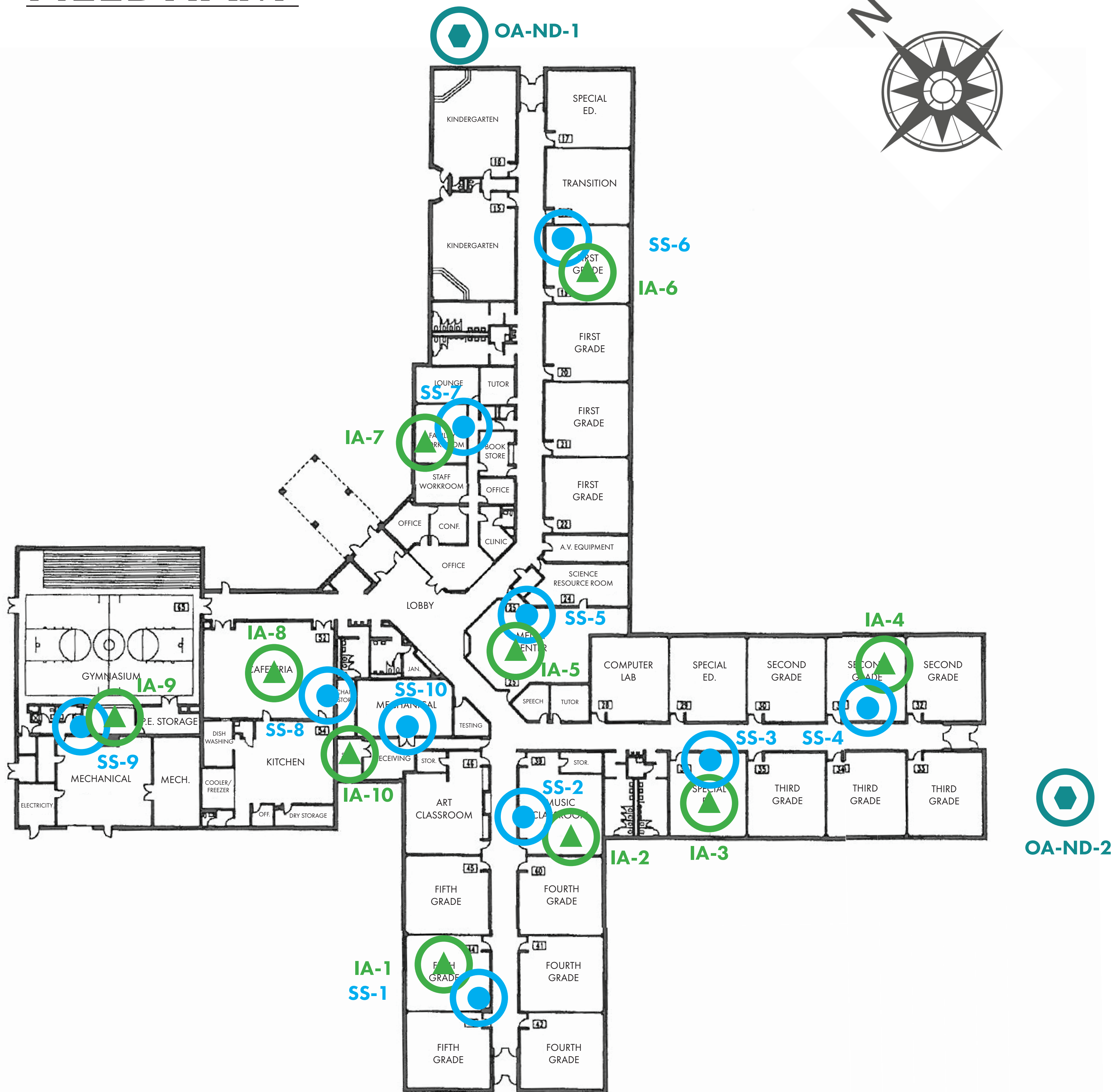

NEEDHAM



INDOOR AIR RESULTS

Sample Address	Sample Identification	Sample Location	Applicable Criteria	March 23 - 8 Hour		March 24-25 - 24 Hour	
				VOCs (µg/m ³)		VOCs (µg/m ³)	
				PCE (µg/m ³)	TCE (µg/m ³)	PCE (µg/m ³)	TCE (µg/m ³)
INDOOR AIR SAMPLES							
Residential Indoor Air Screening Level				42	2.1	42	2.1
Commercial Indoor Air Screening Level				180	8.8	180	8.8
Needham 1339 Upper Shelbyville Road	IA-1	First Floor	Residential	<0.68	<0.54	<0.68	<0.54
	DUP-ND-1 (IA-1)			<0.68	<0.54		
	DUP-ND-2 (IA-1)					<0.68	<0.54
	IA-2			<0.68	<0.54	<0.68	<0.54
	IA-3			<0.68	<0.54	<0.68	<0.54
	IA-4			<0.68	<0.54	<0.68	<0.54
	IA-5			<0.68	<0.54	<0.68	<0.54
	IA-6			<0.68	<0.54	<0.68	<0.54
	IA-7			<0.68	<0.54	<0.68	<0.54
	IA-8			<0.68	<0.54	<0.68	<0.54
IA-9	<0.68	<0.54	<0.68	<0.54			
IA-10	<0.68	<0.54	<0.68	<0.54			

OUTDOOR AIR RESULTS

Sample Address	Sample Identification	Sample Location	Applicable Criteria	VI Assessment	VOCs (µg/m ³)	
					Tetrachloroethene	Trichloroethene
OUTDOOR AIR SAMPLES						
Outdoor Air	OA-ND-1 OA-ND-2	Outside	Not Applicable	8 hour (March 23) 24 hour (March 24)	<0.68 <0.68	<0.54 <0.54

SUB-SLAB RESULTS

Sample Address	Sample Identification	Applicable Criteria	August 2018		March 9, 2019		March 25, 2019	
			VOCs (µg/m ³)		VOCs (µg/m ³)		VOCs (µg/m ³)	
			PCE (µg/m ³)	TCE (µg/m ³)	PCE (µg/m ³)	TCE (µg/m ³)	PCE (µg/m ³)	TCE (µg/m ³)
SUB-SLAB VAPOR SAMPLES								
Residential Sub-Slab Vapor Screening Levels			1,400	70	1,400	70	1,400	70
Commercial Sub-Slab Vapor Screening Levels			6,000	290	6,000	290	6,000	290
Needham 1339 Upper Shelbyville Road	SS-1	Residential	121	<1.07	<31.9	96.2	<31.9	30.6
	DUP-1				<31.9	<10.7		
	SS-2		4.61	<1.07	<31.9	57.5	<31.9	<10.7
	SS-3		<3.19	<1.07	952	36.0	<31.9	<10.7
	SS-4		4.95	<1.07	239	<10.7	<31.9	19.9
	SS-5		<3.19	<1.07	102	53.7	<31.9	<10.7
	SS-6		5.15	<1.07	211	<10.7	<31.9	<10.7
	SS-7		11.3	<1.07	<31.9	<10.7	<31.9	<10.7
	SS-8		<3.19	<1.07	57.0	23.1	<31.9	<10.7
	SS-9		<3.19	<1.07	43.4	23.1	336	<10.7
SS-10	18.4	<1.07	250	100	<31.9	<10.7		