

SUB-SLAB VAPOR

NEEDHAM

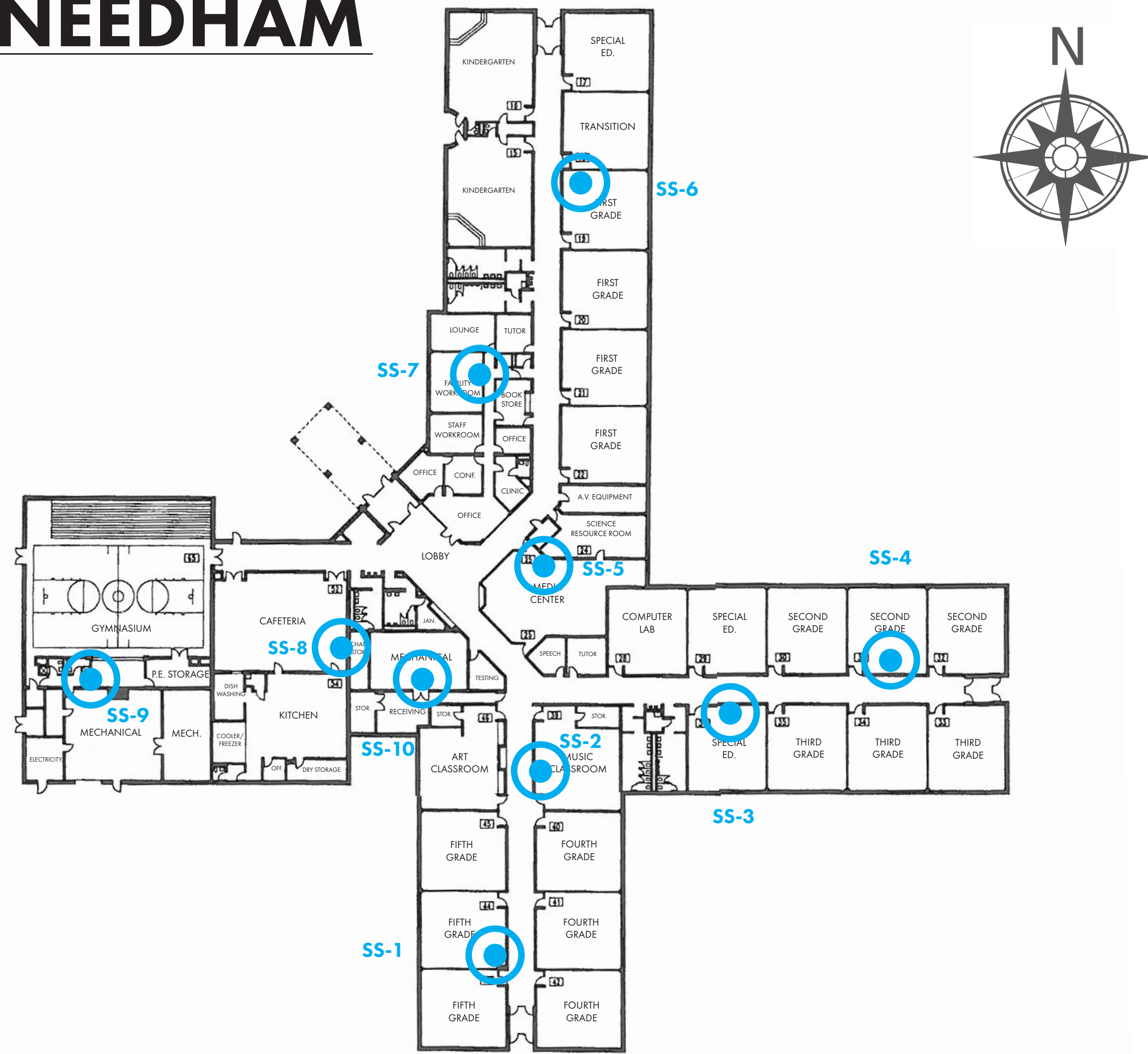

WEBB

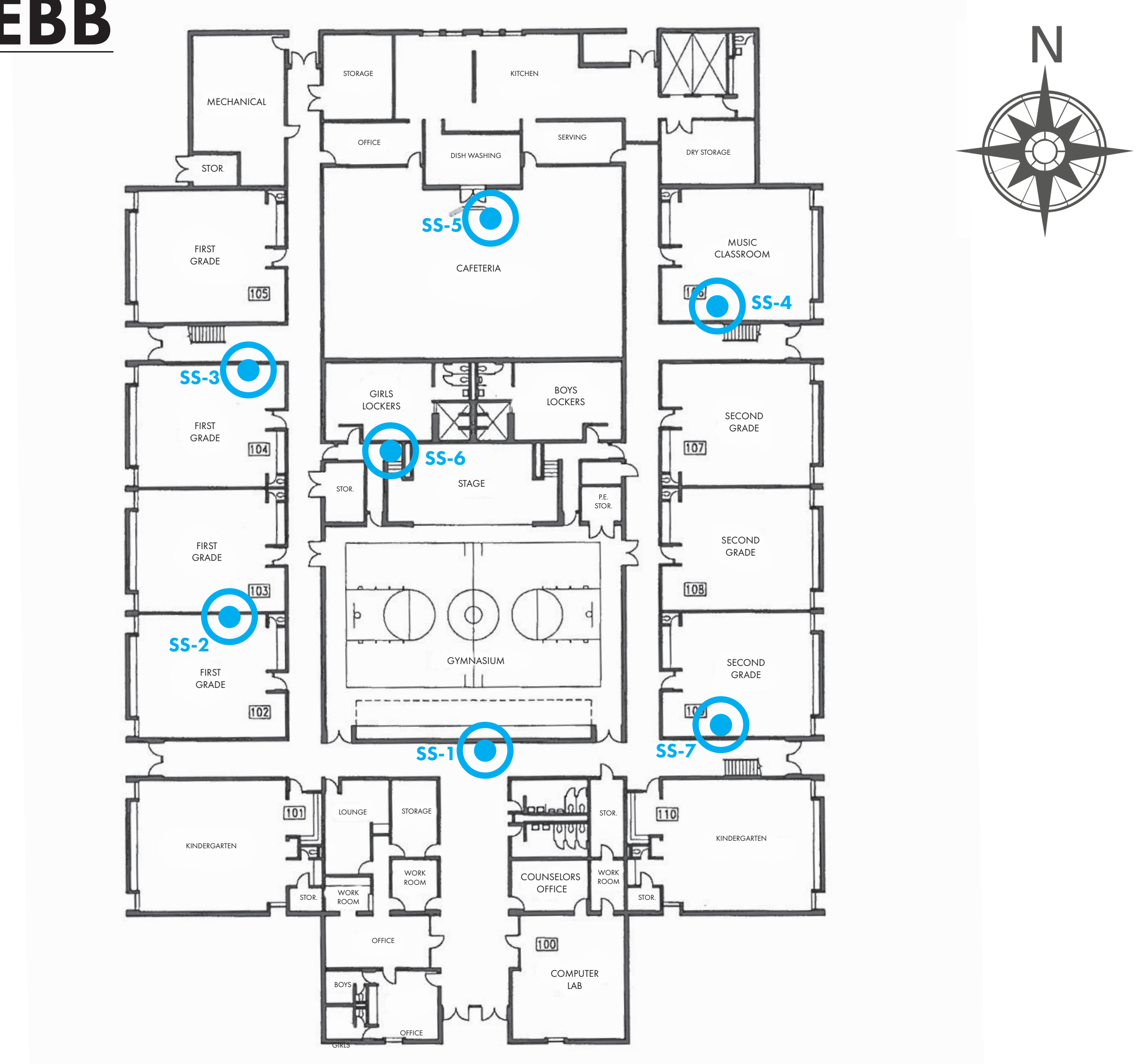

SUB-SLAB RESULTS

Sample Address	Sample Identification	Applicable Criteria	August 2018		March 2019	
			VOCs (µg/m ³)			
			PCE (µg/m ³)	TCE (µg/m ³)	PCE (µg/m ³)	TCE (µg/m ³)
SUB-SLAB VAPOR SAMPLES						
Residential Sub-Slab Vapor Screening Levels			1,400	70	1,400	70
Commercial Sub-Slab Vapor Screening Levels			6,000	290	6,000	290
Needham 1339 Upper Shelbville Road	SS-1	Residential	121	<1.07	<31.9	96.2
	DUP-1		<31.9	<10.7		
	SS-2		4.61	<1.07	<31.9	57.5
	SS-3		<3.19	<1.07	952	36.0
	SS-4		4.95	<1.07	239	<10.7
	SS-5		<3.19	<1.07	102	53.7
	SS-6		5.15	<1.07	211	<10.7
	SS-7		11.3	<1.07	<31.9	<10.7
	SS-8		<3.19	<1.07	57.0	23.1
	SS-9		<3.19	<1.07	43.4	23.1
SS-10	18.4	<1.07	250	100		

SUB-SLAB RESULTS

Sample Address	Sample Identification	Applicable Criteria	August 2018		March 2019	
			VOCs (µg/m ³)			
			PCE (µg/m ³)	TCE (µg/m ³)	PCE (µg/m ³)	TCE (µg/m ³)
SUB-SLAB VAPOR SAMPLES						
Residential Sub-Slab Vapor Screening Levels			1,400	70	1,400	70
Commercial Sub-Slab Vapor Screening Levels			6,000	290	6,000	290
Webb 1400 Webb Court	SS-1	Residential	<3.19	1.24	365	28.5
	SS-2		4.41	1.67	119	242
	SS-3		4.61	<1.07	186	849
	SS-4		3.32	1.34	408	<10.7
	SS-5		12.9	<1.07	235	<10.7
	SS-6		<3.19	54.5	118	225
	SS-7		<3.19	<1.07	209	<10.7